

Item	Qty.	Description
1	1	38.029" GS220 Vertical Extrusion w/ Hinges
2	1	38.029" GS210 Vertical Extrusion
3	1	38.029" GS210 Vertical Extrusion
4	1	38.029" GS220 Vertical Extrusion w/ Hinges
5	1	34.446" Z45 Vertical Extrusion w/ Door Stops
6,6A	2,2	12.5" Z45 Horizontal Extrusion
7,7A	1,1	45.831" Z45 Horizontal Extrusion
8,8A	1,1	50.521" Z45 Curved Horizontal Extrusion
--	4	18" Shelf Support

- Steps:
- 1) Attach horizontals [6] [7] and [8] between verticals [1] [2] [3] and [4].
  - 2) Slide infills between verticals [1 & 2] [2 & 3] and [3 & 4], making sure the Velcro is facing inward.
  - 3) Attach horizontals [6A] [7A] and [8A] between verticals [1] [2] [3] and [4] and on top of infills.
  - 4) Connect doors to verticals [1] and [4]. See [Door Connection](#) detail.
  - 5) Connect **shelf supports** to Velcro on infills, then set shelf on top of supports.
  - 6) Place counter top onto assembly then lock into horizontals [6A]. See [Counter Top Lock](#) detail.
  - 7) Screw standoffs into counter top then attach plex top, using screw caps.

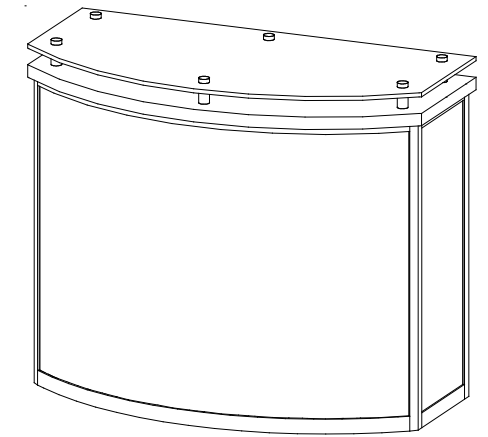

Completed Assembly

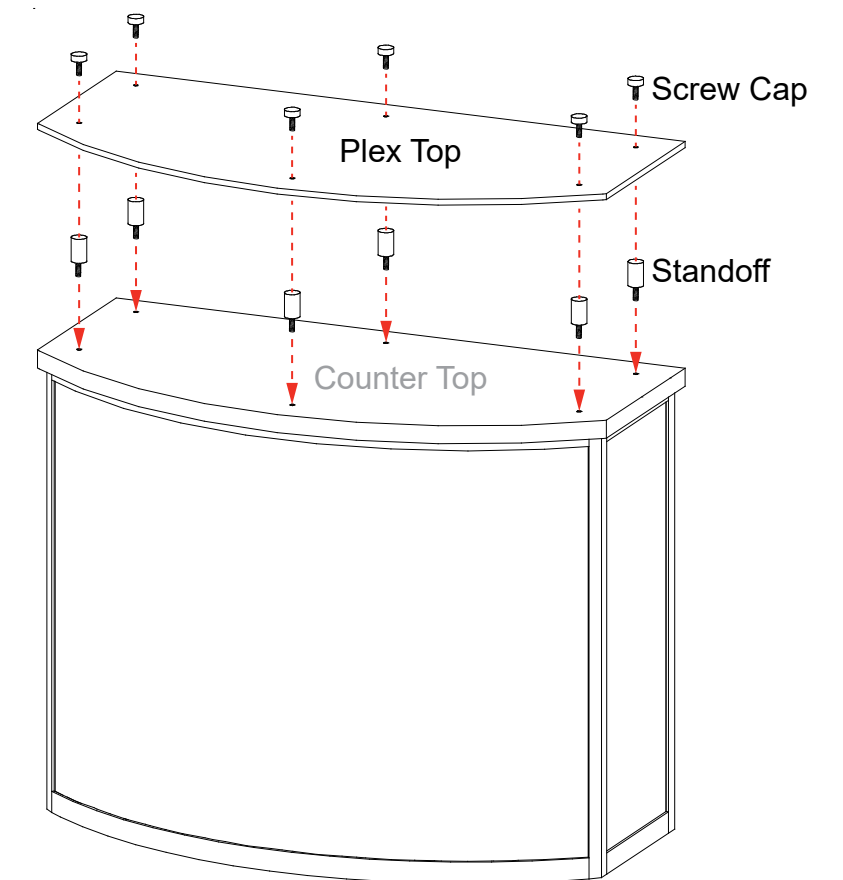
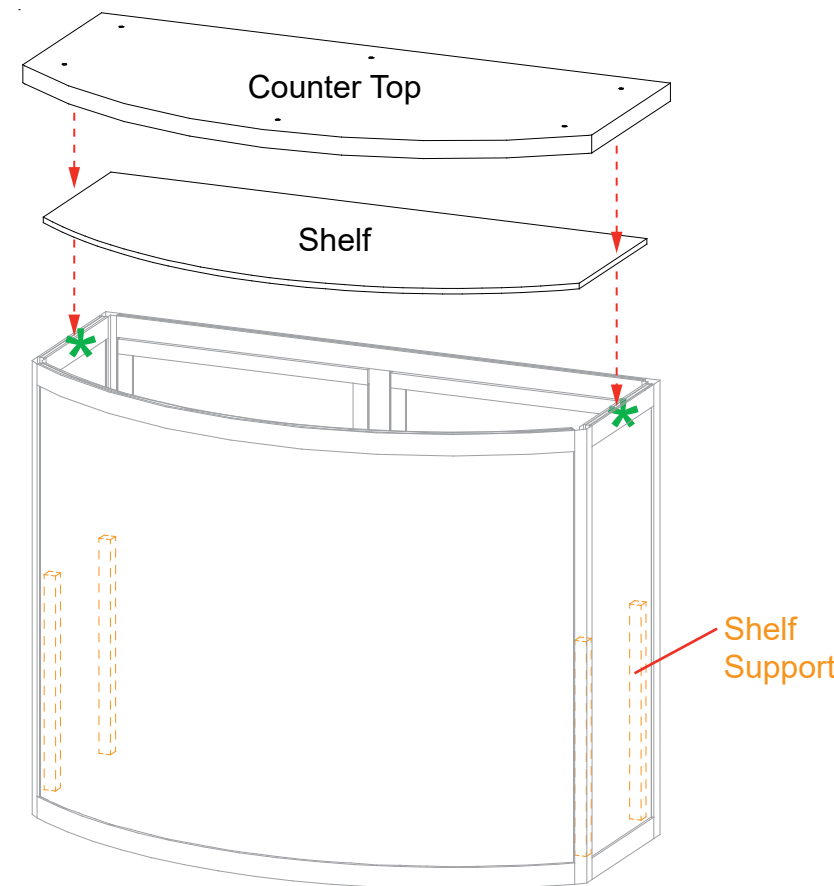
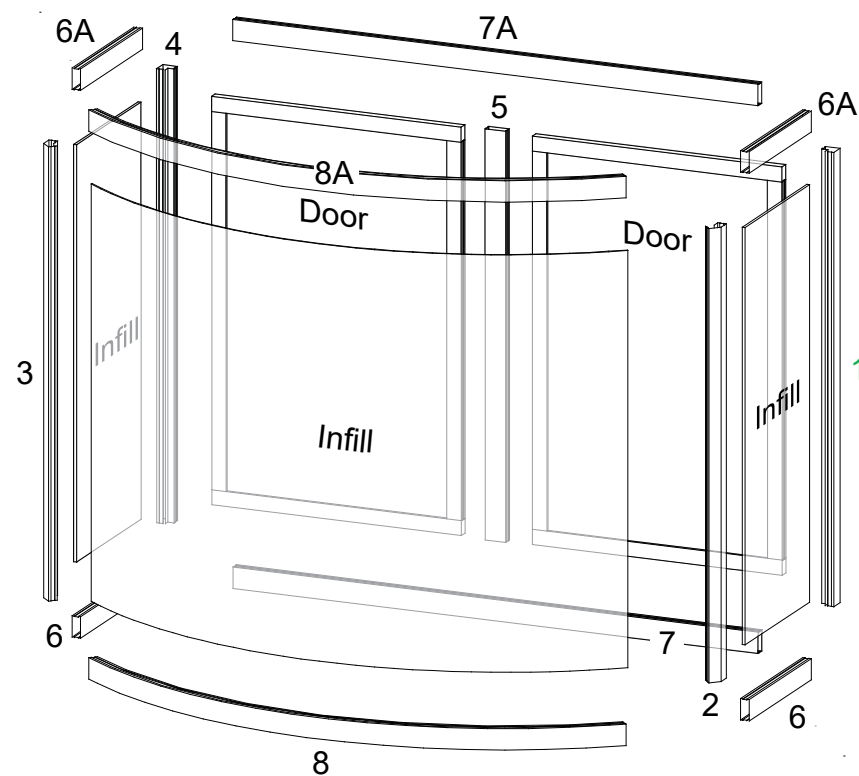
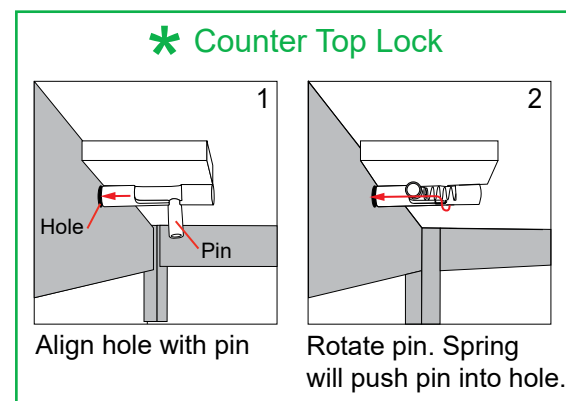

# SETUP INSTRUCTIONS

## General Setup Instructions

- Read entire setup instruction manual prior to unpacking parts and pieces.
- The setup instructions are created specifically for this configuration.
- Setup instructions are laid out sequentially in steps, including exploded views with detailed explanation for assembly.

## Cleaning & Packing

- For Cleaning Metal, Plex, & Laminate Parts: Use a **MILD NON-ABRASIVE** cleanser and soft cloth/paper towel to clean all surfaces.
- Keep exhibit components away from heat and prolonged sun exposure.  
**Heat and UV exposure will warp and fade components.**
- Retain all provided Packing Materials. All provided packing materials are for ease of repacking & component protection.

## Disassembly

- For loss prevention, tighten all set screws and locks during disassembly.

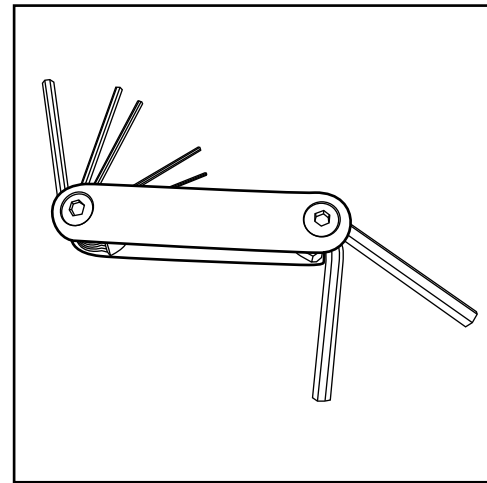

Hex Tool - Essential for Assembly

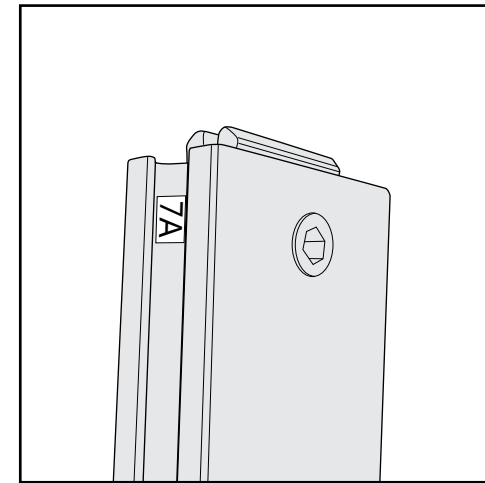

Part Identification - Numbering



Spline Connection



Base Plate & Extrusion Connection



Extrusion & Lock Connection



Engaged Lock



**WARNING**



DO NOT USE POWER TOOLS



LADDERS OR LIFTS  
MAY BE REQUIRED



ALL CONNECTIONS MUST  
BE TIGHTLY SECURED